



# **Tillman**

## ***Family Update***

**January 14, 2024**

Tillman Family - We hope you're staying safe and warm on this frigid weekend. The week ahead looks to be pretty cold, so please review the information below about kids dressing appropriately for cold weather. We greatly appreciate your active participation in our recent parent-teacher conferences and your support of the Book Fair. We're looking forward to having many of you on campus again soon, at Fourth Friday Reading (Jan 26) and our Ribbon Cutting & Open House (Feb 3) - if not before.

As a reminder, there is no school on Monday in recognition of Dr. King's birthday. We'll see kids on Tuesday.

Take care.

Bryan, Max, and your team at Tillman

---

### **Mark Your Calendar**

- Jan 15 (M) - No school, Celebration of MLK, Sustainability work day in courtyard
- Jan 16 (T) - Planned changes to arrival/dismissal routines (weather permitting)
- Jan 23 (T) - PTO meeting/Summer Camp Informational Fair
- Jan 26 (F) - Fourth Friday Reading, 3rd-5th grade Spelling Bee
- Feb 3 (Sa) - Tillman Ribbon Cutting & Open House
- Feb 8 (Th) - Tillman Night at The Magic House
- Feb 15 (Th) - Tillman Night at the Blues Game
- Feb 16 (F) - No school, staff professional development
- Feb 19 (M) - No school, Presidents Day
- Feb 23 (F) - Fourth Friday Reading
- Feb 29 (Th) - Tillman STEAM Night

- Mar 2 (Sa) - Tillman Trivia Night
- Mar 6 (W) - 5th Grade Parent Night at NKMS & Nipher Middle, 6:30

## *New/Updated Information*

### **Fourth Friday Reading - January 26**



As mentioned in last week's Update, we are a better school when our parents and guardians feel welcome in classrooms and are immersed in what we do, as you wish to and are able. We're excited to roll out our Fourth Friday events in the coming months, as an initial opportunity to get our families back into classrooms and celebrating learning with kids. Our first Fourth Friday will be on **January 26**, inviting parents, family members, and other guests to read with our Trailblazers in classrooms.

- We understand that not everyone will be able to attend our Fourth Friday Celebrations, but we hope with advanced notice you'll be able to join us from time-to-time. Future dates this year include **February 23**, **March 29**, and **April 26** (also Good Friday).
- We screen all visitors to Tillman's campus through our [Raptor Visitor Management System](#). Families and other guests who are able to attend on January 26 are strongly urged to pre-register in advance at [tinyurl.com/4thFridayJan26](https://tinyurl.com/4thFridayJan26), enhancing efficiency upon your arrival without compromising security for all involved. We will have visitor badges printed and ready to pick up for those who pre-register, expediting your entrance and allowing the most time possible for you to read with our students. Please bring your license/ID with you to Tillman, whether you have pre-registered or not.
- Additional parking will be available behind Tillman on these mornings, and our doors will open at 8:20 to help us manage ID stickers and security. All students and guests will be invited into classrooms at our normal 8:25 arrival time. The tardy bell rings at 8:40. We will read until approximately 8:50, at which time families are invited to watch our live announcements from classrooms.
- After our announcements have concluded, family members and guests are invited to enjoy light refreshments and good conversation, courtesy of our PTO. Parents of students participating in the Spelling Bee will also be invited to the library at that time.

### **Bundle Up!**

Outdoor play and fresh air are essential to students' overall health and learning, and we prefer to get kids outside for recess when possible. Some indoor recess is likely this week, however, given our general recess guidelines and the current forecast.

1. We will typically have outdoor recess (20-25 minutes) if the temperature and wind chill is 20 degrees or above.
2. Recess will typically be indoors if the temperature or wind chill is below 20 degrees.
3. Some classes may choose to take a short break outside, with restricted time and movement, if temperatures and/or wind chills are between 15-20 degrees.



We strongly encourage students to wear coats, hats, and gloves that are appropriate for winter weather, even if indoor recess is a probability. All students will be outside during arrival and dismissal, even for a short time, and we should always be prepared for an emergency evacuation, should the need arise. Families are invited to review the [Extreme Cold and Winter Weather](#) section on KSD's website for tips and suggestions for managing extreme cold. Please contact our counselors and/or school nurse if your child may need assistance in securing winter-appropriate clothing.

- [Abigail Eichberg](#) (K/2/4 counselor)
- [Kelly FaQuin](#) (1/3/5 counselor)
- [Elizabeth Cresswell](#) (school nurse)

## Kindergarten Registration for 2024-25

Calling all 2024-2025 Kindergarten Families! Kindergarten Registration begins next Friday, on January 19. You can register online at <https://www.kirkwoodschoools.org/register>. Registering early ensures you receive spring communication about kindergarten AND helps us adequately prepare for staffing needs. We thus urge you to go online to register at your earliest convenience. In the meantime, if you have a child who will be attending kindergarten next year, please complete [this short form](#). Questions? Call the Tillman office at 314-213-6150.



## In Friday's Backpack Mail

The Kirkwood School District uses a range of informal and formal assessments to determine the instructional strengths and needs of students, and thus guide how we proceed in supporting their learning. As was the case last year, all K-8 parents and guardians across KSD have received their student's Winter 2023 benchmark screening results via backpack mail.

We are committed to ensuring that our families have a clear understanding of the work we do to monitor and collaboratively contribute to the academic achievement of our students. Additional information is available in the attachment below and at the following links on the KSD website:

- [KSD Assessment site](#)
- [Screening/Benchmark Assessments](#)
- [Understanding Benchmark Results](#)
- [Benchmark FAQs](#)



Intensive	Supplemental	Universal	Supplemental	Intensive
<p>In addition to Universal instruction, a student participates in supplementary small group instruction in areas where improvement is needed.</p> <p>In addition to Universal and Supplemental instruction, the student receives intensive, targeted instruction in areas of concern. Progress is monitored and adjustments are made accordingly.</p>	<p>Classroom/school assessments and daily observations suggest a student would benefit from additional assistant in specific areas.</p> <p>In addition to Universal instruction, the student may participate in supplementary small group instruction in areas where additional support is needed. Progress is monitored and adjustments are made to help the student reach benchmark goals.</p>	<p>Classroom/school assessments and daily observations suggest a student is making grade level progress toward academic, behavioral and social/emotional goals.</p> <p>Universal classroom instruction is meeting a student's needs, and the student is mastering content and reaching benchmark goals.</p>	<p>Classroom/school assessments and daily observations suggest the student is exceeding grade level benchmarks and needs more differentiated or accelerated instruction.</p> <p>In addition to Universal instruction, the student may participate in supplementary small group instruction. Student demonstrates gifted intelligence and character traits that exceed grade level skills.</p>	<p>Student demonstrates gifted intelligence and character traits that far exceed grade level skills.</p> <p>In addition to Universal and Supplemental instruction, the student's success is supported through in-depth exploration in area of giftedness. The student and parents are guided to resources that help ensure that the student is meeting personal goals.</p>

## MTSS Chart 2023-24 School Year.pdf

[Download](#)

316.7 KB

## Courtyard Classroom

Tillman has the opportunity to participate in a [Green Schools Quest](#) (GSQ) Project, sponsored by the MGGBC (Missouri Gateway Green Building Council). Our focus for this project is to transform our new courtyard space into an outdoor classroom that incorporates central themes of the [Rainbow of Sustainability](#). We're being assisted in this project by our Green Schools Mentor, McCarthy Construction.



The "Courtyard Classroom" will feature a (1) Composting Corner where students will participate and learn about the composting process, (2) raised garden beds where students will be starting seeds, planting/harvesting crops, and maintaining the spaces, (3) the chicken coop (to return in Spring 2024), and (4) a Sensory Walk that allows students to center and immerse themselves fully in our enclosed outdoor space. In close proximity to the courtyard is our new STEAM Lab, currently in development, which is and will be accessible by any classroom for STEAM-related projects and other learning.

There will be multiple opportunities for families to support Tillman's Green School Quest. Be on the lookout for information about monthly events to prepare our spaces for the spring and ongoing student use. All resources, handiwork, donations, and enthusiasm are welcome. For more information, contact [Stephanie Nickolotsky](#).



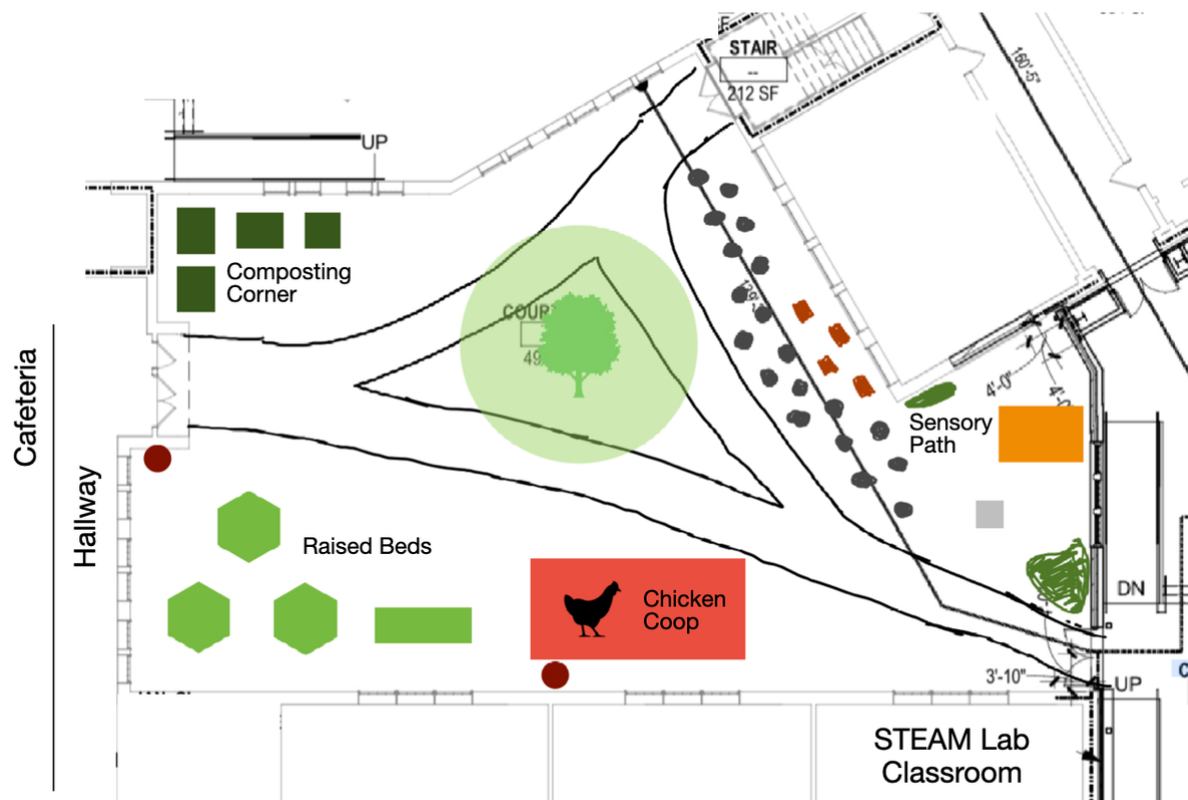

## Lost & Found Items Donated After January 19

While many items were claimed from our Lost & Found last week, we also added quite a few new items. We invite you to stop by school this week, signing in the office, if you'd like to peruse the Lost & Found for any missing coats, sweatshirts, gloves, or lunchboxes. Any items left unclaimed after this week will be donated. You can review our Jan 5 Lost & Found video [HERE](#).



## Trailblazer Cafe

We loved spending time with these terrific Trailblazers on Friday, celebrating their leadership over lunch in Trailblazers Cafe. Thanks for putting the 3 BEs into action!



Kindergarten



1st Grade



2nd Grade



3rd Grade



4th Grade



5th Grade

## *Repeat (and Still Important) Information*

### **Ribbon Cutting & Open House**

We're excited to invite all members of our Tillman Family and the broader KSD community to our official Ribbon Cutting & Open House on **Saturday, February 3** at 9am. In addition to a ribbon cutting, guests will have the opportunity to tour the building, participate in family-friendly activities, and see our new and repurposed spaces.



### **Changes to Arrival & Dismissal Routines Coming Soon**

We now expect to shift morning and afternoon carpools to the rear of the building on Jan 19 or 22. In conjunction with these changes, we will shift bus traffic into the circle loop and away from the outer chute. Please watch for additional information and revised maps in the coming days.

A number of additional items that were previously shared in the Sunday Update are still relevant. In an effort to streamline our weekly communication, we've shifted these repeated items to our Tillman website, under **Our School** → **Family Updates** → [Ongoing Family Information](#). Please look to the website for information about the items listed below.

- Volunteer in the Library
- Magazine Donations for Counseling Center
- Volunteering on Field Trips
- Work on Bioretention Basin

## *PTO Information*

*Additional information about PTO can be found on our [Tillman PTO website](#).*

### **Trailblazers Making a Difference**

Dr. King used his gifts and his voice to stand up for what he believed in and to create change in his community. His powerful speeches and writings continue to inspire families generations later and

his commitment to serving his community is carried on by countless people who engage in a Day of Service on his birthday. In his honor, Tillman Unite would like to recognize all of the world changers that already exist within our community.

- Has your student used their voice or another gift to speak up for what they believe in
- Have they made art, music, written a story, or used their creativity to make change
- Have they served their community/neighbors/family this season?

**If so, we want to hear from you!** Take a picture/draw/write a summary of what you/your family has done to serve or advocate for others and send them to [tillmanunite@gmail.com](mailto:tillmanunite@gmail.com). We will share the great work our students and families are doing in the community (with your permission) and you will be invited to a Trailblazer celebration this spring! We can't wait to hear about all of the great things our students are doing!

## Save the Date: Tillman Unite Book Club

Join us on **Tuesday, February 20 at 7 pm** to discuss *Take My Hand* by Dolen Perkins-Valdez. From Amazon: "Inspired by true events that rocked the nation, a searing and compassionate new {2022} novel about a Black nurse in post-segregation Alabama who blows the whistle on a terrible injustice done to her patients, from the *New York Times* bestselling author of *Wench*."



## Mark Your Calendars - PTO Summer Camp Fair on January 23

PTO is again inviting local camps to our summer camp fair on January 23 (7pm) in Tillman's gym. Parents can ask questions, gather informational materials, and decide which programs would be a good fit for their children. Non-Tillman families are welcome to attend. Childcare will be provided.

## Tillman Express Fund

Express Fund is the PTO's no-hassle/no-selling fundraising tradition and one of the largest sources of income for our organization. All students directly benefit from the PTO, which provides teacher grants and stipends, funding for school projects and field trips, community building activities, and financial assistance as needed in the school community. A donation of \$35 per student is recommended for meeting our budget goals, but any amount helps. There is also an optional "Trailblazer Level" of \$100 which comes with the opportunity to win various prizes throughout the year! You can make your tax-deductible donation via [MySchoolBucks](https://www.myschoolbucks.com).

A number of additional PTO items that were previously shared are still relevant. In an effort to streamline our weekly communication, we've shifted these repeated items to our PTO website, under Our School --> PTO --> [PTO Updates & Information](https://www.myschoolbucks.com). Please look to the website for information about the items listed below.

- New Position for PTO Board
- Tillman Express Fund
- Tillman Night at the Blues Game - Feb 15
- Trivia Night - March 2
- Tillman Unite Book Club
- Spirit Wear (now available ALL year)



- Sign-up Parties for Adults
- Room Parent & Classroom Party Volunteers Needed
- Additional Volunteer Opportunities - Sustainability, 5th Grade Celebration, Tillman Unite
- New Student Welcome Sign Return
- Buzz Book

## KSD Information & Updates

### Many Cultures, One Kirkwood

We are excited to announce KSD will be hosting our fourth annual Many Cultures, One Kirkwood event. This grand celebration of world cultures will take place on **Friday, March 1** from 6-8 pm in the gym/cafeteria at North Kirkwood Middle School, 11287 Manchester Road. If you are interested in participating or volunteering for the event, please sign up by visiting:

[kirkwoodschoools.org/manycultures](http://kirkwoodschoools.org/manycultures).



### KSD NOW - 2nd Semester Registration

Kirkwood School District offers the [KSD Nutrition on the Weekends \(NOW\)](#) program to supply an array of nutritious, non-perishable meals and snacks for children experiencing food insecurity, free of charge. Boxes are distributed to families at their homes via delivery in a discrete and caring manner once per month. If you wish for your child(ren) to participate in the program, please complete the form below.

- In order to receive support through KSD NOW, please complete the online registration at <https://www.kirkwoodschoools.org/KSDNOWRegistration>. If you have any questions, please contact program coordinator Emilie Lytton at [ksdnow@kirkwoodschoools.org](mailto:ksdnow@kirkwoodschoools.org). All inquiries will remain confidential.
- We welcome your financial contribution to keep KSD NOW running to support our students. We continue to accept online donations via our [online giving campaign](#). For an update on KSD NOW and the program, please read their [most recent newsletter](#).

**KSD**  
eSpotlight



Family Update Archive



Latest KSD Spotlight

Latest BOE News



Tillman Peachjar



Buzz Book



Spirit Wear

---

**Printable Family Calendar - Updated Jan 12**

**KSD Calendar - 2024-25 SY**

---

*Digital Flyers*

CELEBRATING THE LIFE AND LEGACY OF

## DR. MARTIN LUTHER KING JR.

Monday January 15, 2024

1:00 –2:00 p.m.

Keating Center, Kirkwood High School

801 West Essex 63122

### KEYNOTE SPEAKER

**Missouri Supreme Court Justice Robin Ransom**

The first African-American woman appointed to the State Supreme Court

COMMUNITY GOSPEL CHOIR OF ST. LOUIS

Student Participants

Social Justice groups will have information tables before/after the event

### SPONSORED BY:

Meacham Park Neighborhood Improvement Association

Kirkwood Social Justice Coalition

Kirkwood Human Rights Commission

Kirkwood School District



**Prop R** Kids and Community

### Ribbon Cutting & Open House Celebration at Tillman Elementary

Saturday, February 3 at 9-11 a.m.  
230 Quan Ave, Kirkwood, MO 63122

The public is invited to join Tillman staff, students and families as we celebrate the completion of construction.

Celebrate our new Prop R construction projects, including:

- Eight additional classrooms
- Dan Mueller Library
- New Gym
- Andrew Johnson Counseling Center

TAKE A TOUR OF TILLMAN

PARTICIPATE IN FAMILY-FRIENDLY ACTIVITIES

The project was made possible thanks to the community's support for Prop R.

# RIBBON CUTTING







**Tillman Summer Camp Fair**

We would love to see you there!

Come check out all the **AMAZING** camp options the area has to offer!

**Tuesday, January 23rd**

located in the Tillman library

**Camps:**

- Des Peres Lodge
- Master Kim Martial Arts
- Laumeier Summer Art Camps
- VETTA
- Adventure Club
- and many more...

**7pm**

NOTE: Kirkwood School District and Tillman PTO do not endorse and are not responsible for the businesses or services advertised in this flyer or present at the event itself



**PLEASE JOIN US**

**Many Cultures**

**One KIRKWOOD**

**Friday, March 1, 6-8 p.m.**

**North Kirkwood Middle School**  
11287 Manchester Rd.

**Purpose:**

1. Recognize our cultural and ethnic roots.
2. Promote inter-cultural awareness.
3. Celebrate our diversity.

**Join us for:**

1. Parade of Nations
2. International Cultural Performances
3. Cultural Displays

**Volunteer and sign up by visiting**  
[kirkwoodschools.org/ManyCultures](http://kirkwoodschools.org/ManyCultures)

**For questions, please contact:**  
Amy Randles [Amy.Randles@kirkwoodschools.org](mailto:Amy.Randles@kirkwoodschools.org),  
Gina Muller, [Gina.Muller@kirkwoodschools.org](mailto:Gina.Muller@kirkwoodschools.org) or  
Azniv Tcherkezian, [Azniv.Tcherkezian@kirkwoodschools.org](mailto:Azniv.Tcherkezian@kirkwoodschools.org)





### Tillman Elementary School

Email: [tillman.news@kirkwoodschoools.org](mailto:tillman.news@kirkwoodschoools.org)

Website: <https://www.kirkwoodschoools.org/tillman>

Location: [230 Quan Avenue, Kirkwood, MO](#)

Phone: [314-213-6150](tel:314-213-6150)

Facebook: <https://www.facebook.com/TillmanElementary>



### Tillman Elementary

Tillman is using Smore to create beautiful newsletters